

0.26 ACRES, SUNSET RIDGE RD

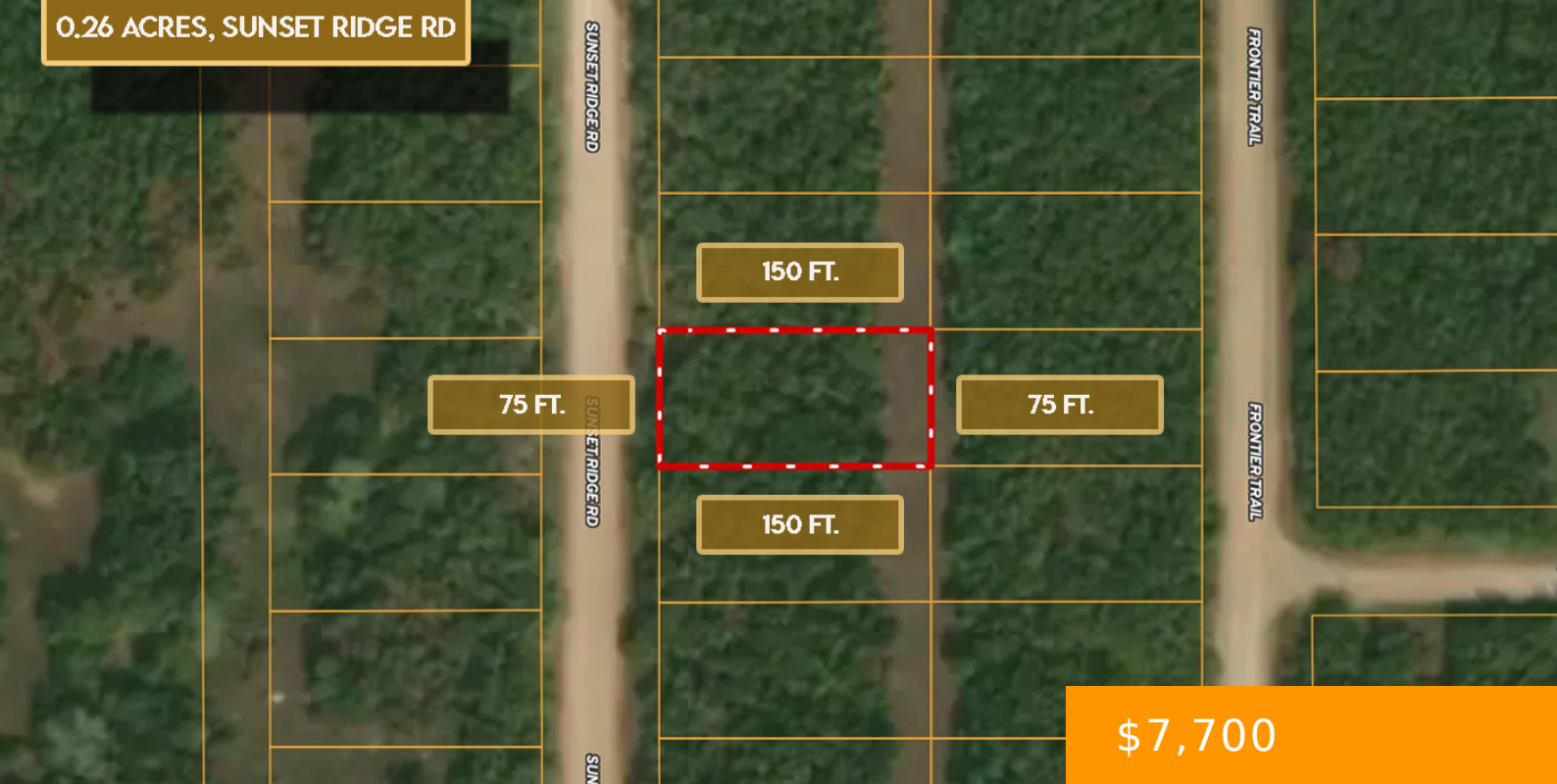

\$7,700

• Available

## .26 ACRES, SUNSET RIDGE RD, OSAGE, OK 74054 - APN: 28-21-09-06150

<https://bubsland.com>

This 0.26-acre lot in the Frontier Shores Subdivision offers a rare opportunity to own a piece of paradise near Lake Keystone, perfect for mobile, manufactured, tiny home or site-built homes. Power and water are available at the street, ready for your future home or getaway. The property is just minutes away from the community boat...

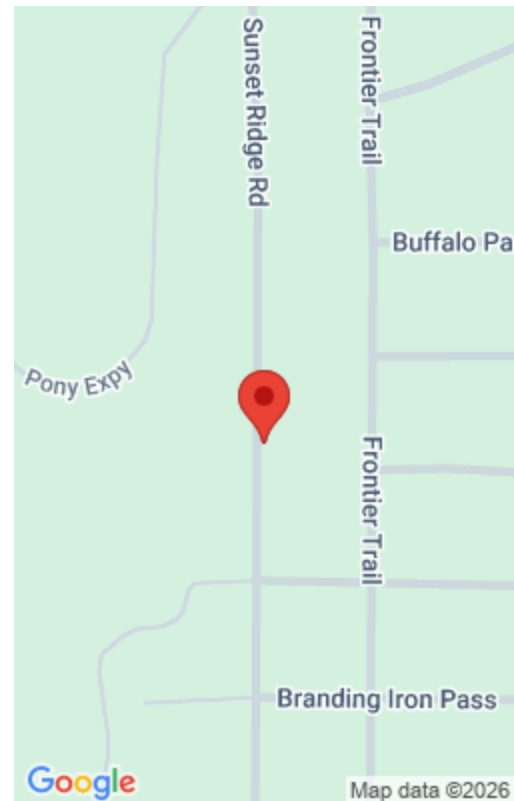

## Property Details



### Call us now

Phone: 573-400-3020

Email: [Sales@Bubsland.com](mailto:Sales@Bubsland.com)

**Cash Price:** 7099

**Term Option 2:** \$250 down, \$250 for 31 months, for a total price of \$8,000

**Google Map Link:** [Driving Directions](#)

**Northwest Corner:** 36.2685, -96.3529

**Southwest Corner:** 36.2683, -96.3529

**Legal Description:** Frontier Shores I Lot 113

**Terrain:** Uneven

**Power:** Provided by Verdigris Valley Electric Cooperative (918-371-2584)

**Water Fees Per Year:** \$0

**Zoning:** Residential

**Mobile Home Living:** Allowed

**Tiny Homes:** Allowed

**POA Fees Per Year:** \$50

**Road Fee:** \$0

**Conveyance:** Warranty Deed

**Term Option 1:** \$200 down, \$200 for 41 months, for a total price of \$8,400

**Term Option 3:** \$350 down, \$350 for 21 months, for a total price of \$7,700

**GPS Coordinates (center) at the road:**  
36.2684,-96.3529

**Northeast Corner:** 36.2685, -96.3524

**Southeast Corner:** 36.2683, -96.3524

**Elevation:** 890'

**Access:** Gravel Road

**Water:** Provided by Frontier Shores Water Department (918) 354-2200

**Sewer:** Provided by Osage Septic Service (918) 428-4578

**RV Living:** Allowed (temporarily)

**Manufactured Homes:** Allowed

**POA:** Frontier Shores

**Taxes Per Year:** \$2

**County Contact Information:** Call Osage County Planning and Zoning Department (918) 287-3981

---

## Basics

**CASH DISCOUNT PRICE:** 7099

**Acres:** 0.26

**County:** Osage

**Status:** Available

**Parcel ID:** 28-21-09-06150

**Approx Dimensions:** 75' x 150' x 75' x 150'

**State:** Oklahoma



**Call us now**

Phone: 573-400-3020

Email: [Sales@Bubsland.com](mailto:Sales@Bubsland.com)