

"0.34-ACRE LOT LOCATED IN CHOUTEAU, OKLAHOMA"

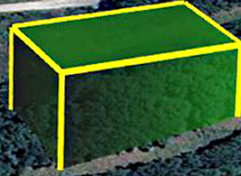

\$13,500

• Available

**0.34 ACRES, CREST DR, CHOUTEAU, OK
74337 APN: 006377-002026-000000**

<https://bubsland.com>

Owner Financing Available - 0.34-Acre Lot in Lake Crest Subdivision ! Build your dream home or weekend retreat on this 0.34-acre lot in the tranquil Lake Crest Subdivision of Wagoner County, Oklahoma. With no HOA restrictions, you have the flexibility to choose a mobile home, manufactured home, or site-built residence that fits your lifestyle. Just...

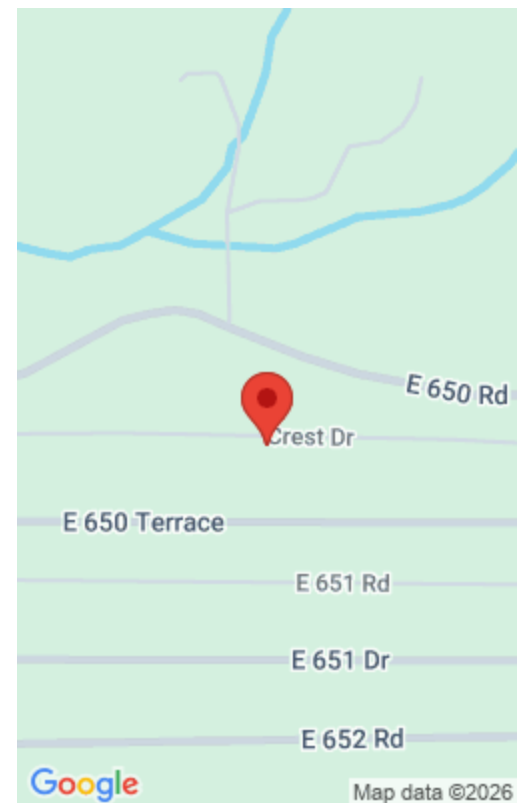

Property Details



Call us now

Phone: 573-400-3020

Email: Sales@Bubsland.com

Cash Price: 11987

Term Option 2: \$350 down, \$350 for 39 months, for a total price of \$14,000

Google Map Link: [Driving Directions](#)

Northwest Corner: 36.0746, -95.2921

Southwest Corner: 36.0744, -95.2921

Legal Description: Lake Crest III Lots 26 & 27 Blk 2

Terrain: Uneven

Power: Provided by Lake Region Electric Cooperative (918) 772-2526

Water Fees Per Year: \$0

Zoning: AG - Agriculture General District

Mobile Home Living: Allowed

POA: None

Road Fee: \$0

Conveyance: Warranty Deed

Term Option 1: \$250 down, \$250 for 60 months, for a total price of \$15,250

Term Option 3: \$450 down, \$450 for 29 months, for a total price of \$13,500

GPS Coordinates (center) at the road: 36.0746, -95.2919

Northeast Corner: 36.0746, -95.2916

Southeast Corner: 36.0743, -95.2916

Elevation: 690'

Access: Dirt Road

Water: Provided by Mayes Co RWD #2 ((918) 476-8992) or Well

Sewer: A Septic Tank is Required

RV Living: Not Allowed

Manufactured Homes: Allowed

Taxes Per Year: \$29.00

County Contact Information: Call Wagoner County Planning & Zoning at: (918) 485-8123

Basics

CASH DISCOUNT PRICE: 11987

Acres: 0.34

County: Wagoner

Status: Available

Parcel ID: 006377-002026-000000

Approx Dimensions: 149' x 100' x 149' x 100'

State: Oklahoma



Call us now

Phone: 573-400-3020

Email: Sales@Bubsland.com